



Sligo Graph Ltd,
Unit 8a,
Dublin Road Business Park,
Carraroe, Sligo

Tel: +353 (0) 71 9153810

Fax: +353 (0) 71 9153819

Email: sales@sgeducation.ie



Tel: 071 9153810 Fax: 071 9153819 Email: sales@sgeducation.ie

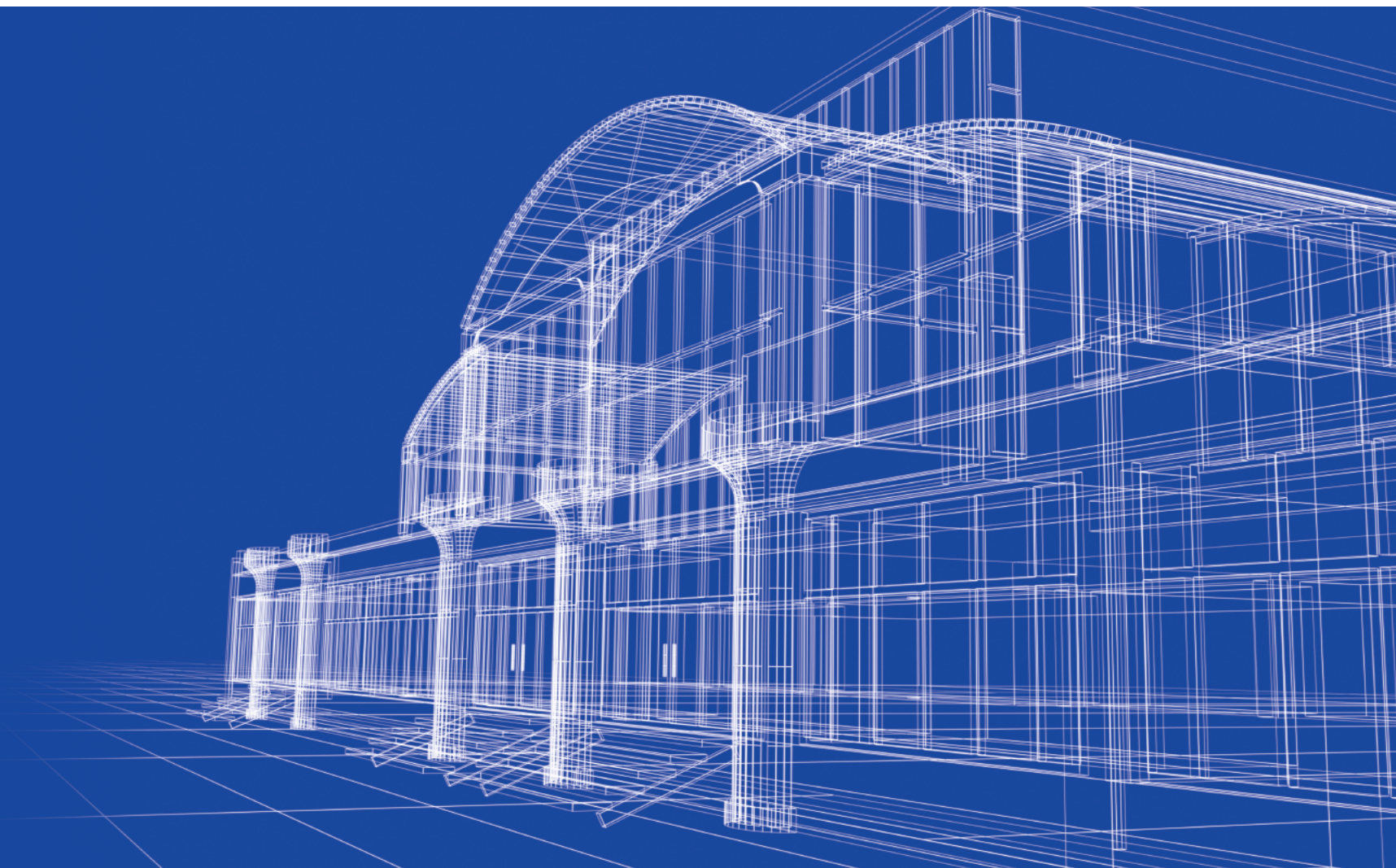

Drawing boards - Floor standing	1
Drawing boards - Portable	3
Drawing boards - Light boards	4
Scale Rules	5
Portfolios	8
Models & Modelling equipment	9
Papers & Foam board	12
Technical drawing equipment	15
Filing & Storage Solutions	19

Visit: www.sgeducation.ie



The Forum

The Forum drawing unit is of a tubular steel construction with maximum stability due to its large footprint.

It has a board height adjustment range of 370mm from a minimum horizontal height of 750mm.

A mechanism enables the height and angle of the board to be easily balanced and locked by means of a simple single lever which is fully retractable.

The stand is suitable for A1, A0 and 42" size drawing boards.

Available in White, Red & Black

The unit is shown with an A1 Superboard, and a Weymouth parallel motion.

Forum/Weymouth A1 Unit	0572.2201
Forum/Weymouth A0 Unit	0572.2401
Forum/Weymouth 42" Unit	0572.2901
Forum Drawing Stand only	0552.001



Champion MkII

The Champion MkII is an improved version of the classic A-frame design.

The unit includes a clear PVC straight edge which can be locked using the top rail brake.

The white tubular frame can be folded flat for ease of storage and is fully height and angle adjustable.

The unit is designed for self-assembly for which full assembly instructions are included.

Champion MkII A1 Unit	0567.321
Champion MkII A0 Unit	0567.341



3 in 1 Cadet Unit

A unique 3-in-1 Designer desk of simple, rugged tubular construction to meet the needs of most general design and graphics work. The unit is especially applicable for CDT Educational Courses. 850mm high. Alternative heights are available on request. Can be used as follows:

Flat Top Desk or Reference Table

Angled Drawing Board: A release locking pin at the side of the unit allows the work surface to tilt 17° before locking.

Drawing Board/Parallel Motion: The board can be set to one of 4 angles and is supplied complete with a Trueline Parallel Motion unit.

A2 Size Cadet Unit	0599.4101
A1 Size Cadet Unit	0599.3101





Trueline

The Trueline is a portable board and cross wire parallel motion system incorporating a simple cam brake to both ends of the graduated straightedge.

The straightedge is undercut to provide inking edges and can be tilted or raised for flexible use. The pulleys are protected by moulded corner blocks.

A3 Trueline Unit	0525.001
A2 Trueline Unit	0525.011
A1 Trueline Unit	0525.021



Supplied with a flip leg/carrying handle stand.

Challenge Lightboard

Utilising the Trueline/Sherbourne unit design, the lightboard uses standard angle lamp or fluorescent lamps (not included) as its light source. The steel backstand supports a translucent acrylic working surface which can be set to four angle positions.

The straightedge is graduated. The wire-type motion system runs along both edges.

A2 Challenge Lightboard	0526.011
A1 Challenge Lightboard	0526.021



Trueline/Sherbourne

A simple combination of the Trueline unit and Sherbourne backstand.

The stand is of an all steel construction and designed for use with A1 and A2 boards with four angle settings.

A2 Trueline/Sherbourne Unit	0564.111
A1 Trueline/Sherbourne Unit	0564.121
Sherbourne Stand only	0544.001



Challenge

This portable board unit is a design hybrid of the Trueline unit with a simple cross-wire parallel motion and graduated straightedge. Supplied with a flip leg/carrying handle stand.

A3 Challenge Unit	0524.501
A2 Challenge Unit	0524.511
A1 Challenge Unit	0524.521



Weymouth/Sherbourne Major

The Sherborne Major backstand is a more robust version of the Sherborne stand.

It is designed to carry heavier boards fitted with the Weymouth parallel motion system.

A1 Weymouth /Sherborne Major	0565.221
42" Weymouth/Sherborne Major	0565.291
Sherborne Major backstand	0545.001



Challenge/Ferndown

A combination of the Challenge unit and the Ferndown stand.

The stand is of an all steel construction with four angle positions that also acts as a carrying handle.

A2 Challenge/Ferndown Unit	0563.511
A1 Challenge/Ferndown Unit	0563.521





Plan Chests

Blundell Harling is renowned for manufacturing a range of heavy duty plan chests.

Our plan chests are built to the highest standard and are compliant with Health and Safety and Data Protection requirements. The chests are lockable and have an anti-tilt mechanism.

Due to the heavy-duty nature of these products they require specialist delivery and installation.

A four week delivery time applies to all Blundell Harling cabinets.



Filing Cabinet

Our range of heavy duty 3 drawer filing cabinets have been specially designed to hold 3 x 23" (58.4cm) rows of A3 files.

The cabinet has heavy duty ball bearing slides for ease of action. It is lockable and has a high quality anti-tilt mechanism, making it compliant with Health & Safety requirements.

Practicality of the cabinet can be increased by inserting a 9" (23cm) tall metal support (Toastrack) into each drawer creating 5 separate storage compartments (supplied as an optional extra).

Choices of colours and handles are available.

Dimensions: W: 24" (61cm), D: 26" (66cm), H: 52" (132cm)

Capacity: 69" (175cm)



Gateshead Millennium Bridge is the world's first and only tilting bridge.

It spans the River Tyne in England between Gateshead on the south bank, and Newcastle upon Tyne on the north bank.

Already acclaimed worldwide for its physical and aesthetic beauty, it has fast become a significant tourist attraction in its own right.

The construction of the bridge won the architects Wilkinson Eyre the 2002 Royal Institute of British Architects (RIBA) Stirling Prize and won Gifford the 2003 IStructE Supreme Award. In winning the Stirling Prize Wilkinson Eyre became the first, and so far the only, firm of architects to retain British architecture's most prestigious prize - after winning the prize in 2001 for the Magna Science Adventure Centre.

In 2005, the bridge received the Outstanding Structure Award from IABSE (International Association for Bridge and Structural Engineering).

